

Tulip Embryo Transfer Catheter

Preshaped with Tulip shaped bulb

Ultra thin embryo transfer catheter

The Tulip catheter is a thin embryo transfer catheter with a bulb at the end of the guiding catheter and a very thin loading catheter.

Tulip bulb for atraumatic entry

The bulb at the distal end of the guiding catheter is rounded and narrow to enable atraumatic entry through the cervical canal.

Curved but shapeable

The guiding catheter is preshaped and ideally curved for easy entry through the cervical canal, even when the uterus is flexed.

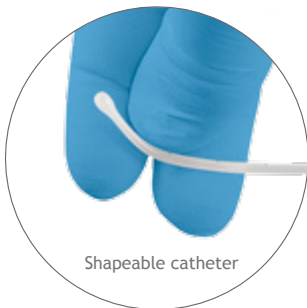

The guiding catheter can easily be shaped to better accommodate difficult patients.

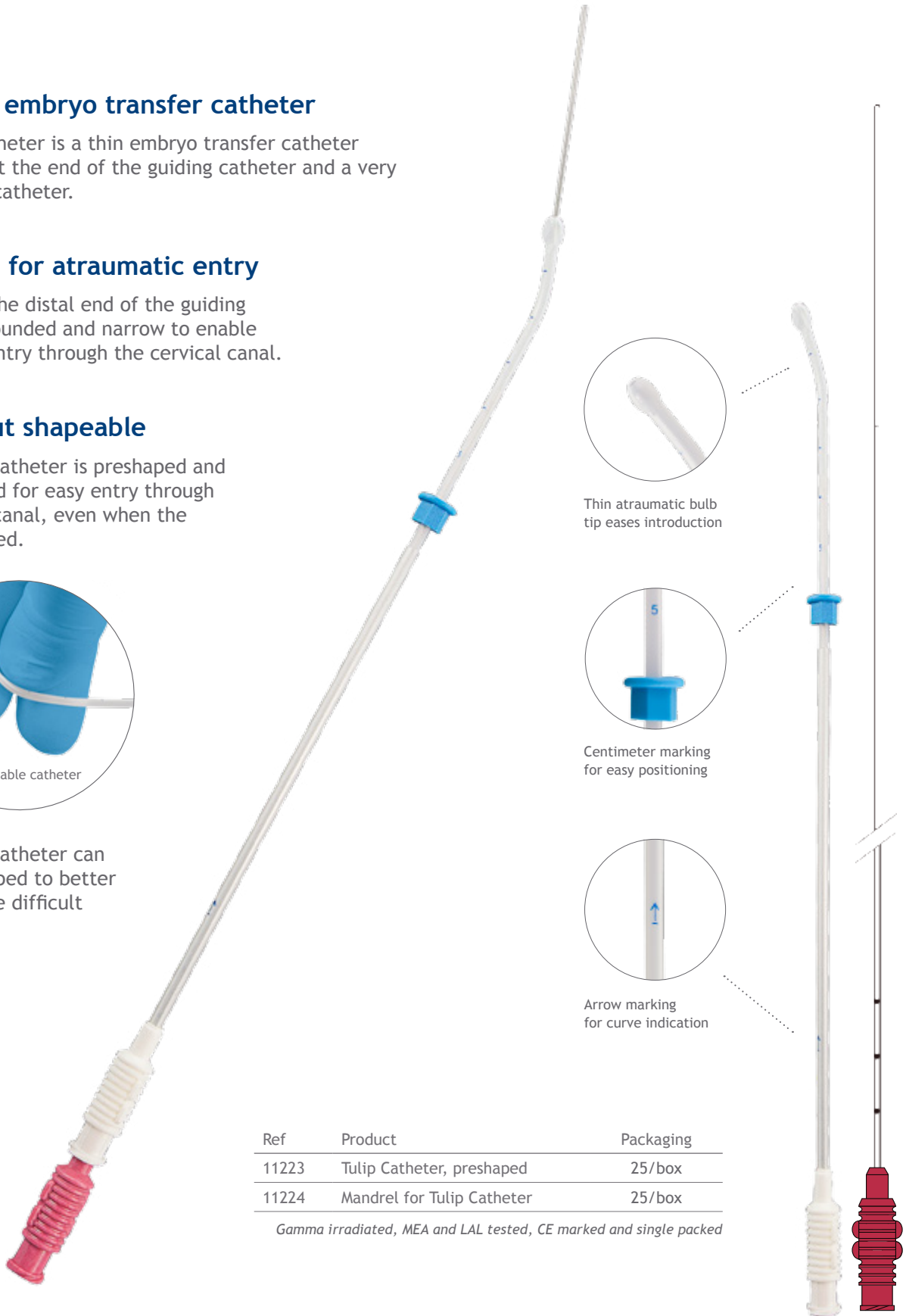

Ref	Product	Packaging
11223	Tulip Catheter, preshaped	25/box
11224	Mandrel for Tulip Catheter	25/box

Gamma irradiated, MEA and LAL tested, CE marked and single packed